

SITE PREPARATION FOR CONCRETE BOLLARD INSTALLATION

STEP 1

ATTACH (2) EYENUTS TO THE CONCRETE BOLLARD 1/2-13 THREADED STUDS. USE CRANE OR WINCH TO LIFT BOLLARD UP. STRAPS OR CHAINS SHOULD BE RATED TO 1000 POUNDS.

THREAD (4) 1/2"-13 X 6" GRADE 8 HEX BOLTS INTO BOTTOM OF CONCRETE. LEAVE 5" OF BOLT STICKING OUT OF THE CONCRETE AFTER THREADING.

DRILL (4) 1.5" DIAMETER HOLES 6" DEEP. HOLES MUST BE PLUMB. CLEAN OUT HOLES AFTER DRILLING

TOP SURFACE OF FOOTER MUST BE LEVEL. DRILL HOLES TO PATTERN SPECIFICATION

GROUND

CONCRETE FOOTER MAKE MIN 25" X 15" X 18" DEEP.

GRAVEL BASE

40"
WIRE LENGTH
ABOVE GROUND

18"
CONCRETE

18"
GRAVEL

ELECTRICAL
SUPPLY WIRE

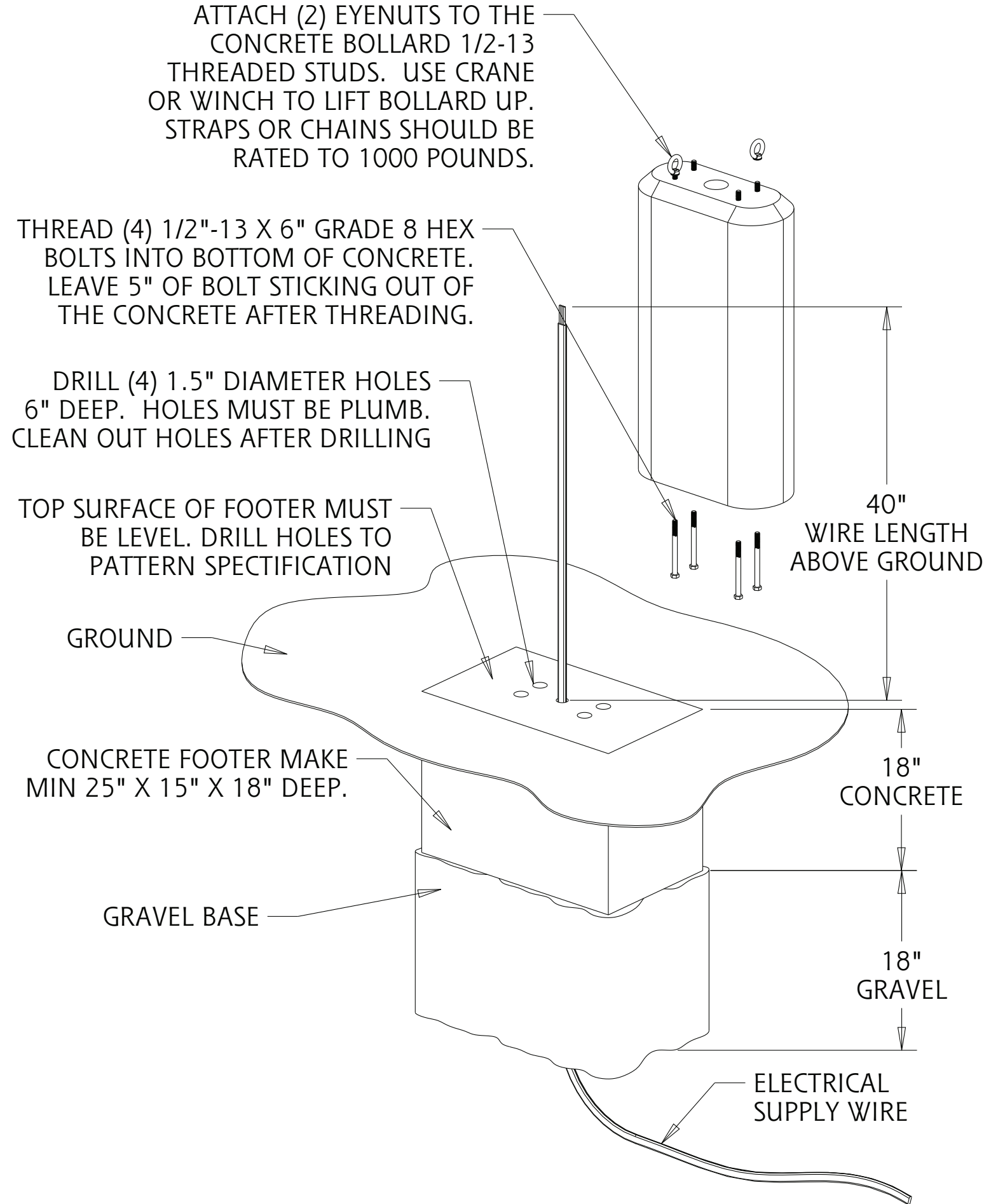

SITE PREPARATION FOR CONCRETE BOLLARD INSTALLATION STEP 2

ONLY AFTER BOLLARD IS RESTING IN THE EPOXY SHOULD YOU REMOVE THE EYENUTS. THE BOLLARD MAY NEED TO BE RAISED AND LOWERED FREQUENTLY TO SET IT PLUMB.

LOWER BOLLARD OVER THE SUPPLY WIRE. GUIDING IT THROUGH THE CENTER HOLE. DRY FIT AND CHECK LEVEL. USE PLASTIC SHIMS TO ADJUST PLUMB OF CONCRETE BOLLARD PRIOR TO MIXING EPOXY

LIFT BOLLARD OFF WITHOUT DISTURBING THE SHIMS IF USED. CLEAN OUT THE HOLES IF NOT ALREADY CLEAN

GROUND LEVEL

MIX ENOUGH 2 PART EPOXY TO FILL THE DRILLED HOLES NEARLY FULL. LOWER THE BOLLARD BACK ONTO THE FOOTER GUIDING THE BOLTS INTO THE DRILLED HOLES RESTING BACK IN THE PLUMB POSITION ON THE SHIMS IF USED. THE BOLLARD WITH ANCHOR BOLTS WILL CAUSE THIS MIX TO COMPLETELY FILL THE HOLES LOCKING THE ANCHORS IN PLACE AFTER CURING OVER NIGHT.

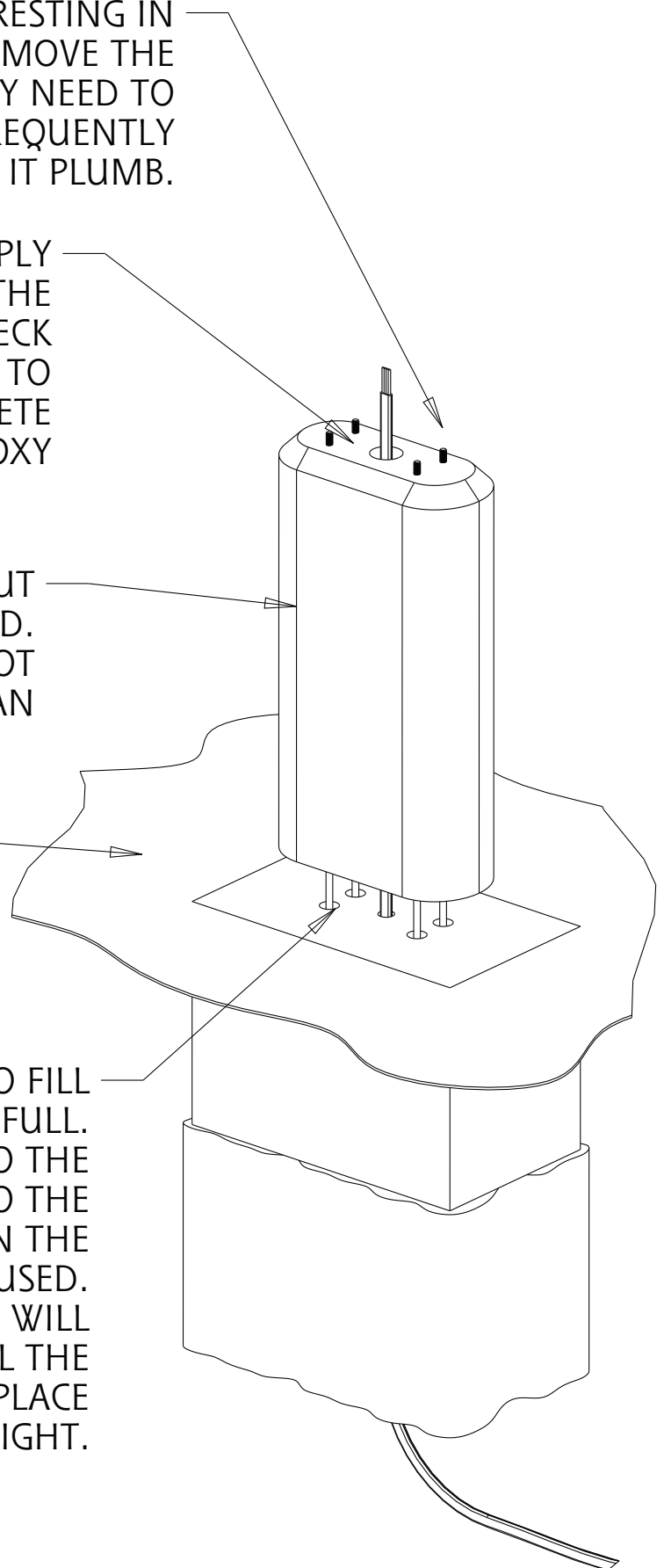

SITE INSTALLATION OF THE BOLLARD MOUNT CHARGER STEP 3

LOWER ASSEMBLED CHARGER
BACK PANEL ONTO THE THREADED
BOLLARD POSTS. BOTTOM OF
CHARGER SHOULD REST COMPLETELY
FLAT ON THE TOP OF THE CONCRETE.

USE WASHER AND 1/2-13 NUT
TO SECURE THE BACK PANEL
ONTO THE BOLLARD BASE.
4 PLACES

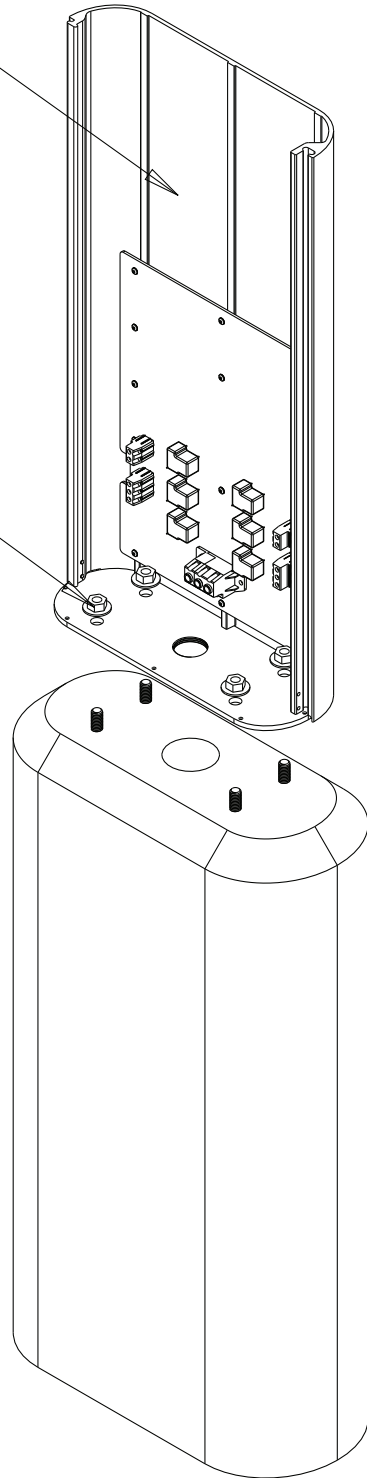

SITE INSTALLATION OF THE BOLLARD MOUNT CHARGER STEP 4

SLIDE CHARGER FRONT ASSEMBLY
DOWN ONTO BACK PANEL ALLOWING
THE SPRING LOCK TO HOLD FRONT
PANEL IN THE SERVICE CONNECT
POSITION AS SHOWN.

MAKE ALL INTERNAL WIRED
CONNECTIONS INCLUDING THE
SUPPLY LINE CONNECTIONS.

AFTER ELECTRICAL CONNECTIONS
ARE MADE RELEASE THE SPRING
LOCK AND SLIDE THE FRONT ALL
THE WAY DOWN TO THE BOTTOM
OF THE BACK PANEL. ONCE DOWN
INSERT THE SETSCREWS TO LOCK
THE COVERS TOGETHER.

